

Description

Parthos Slimline & Lightweight Movable Wall System, Non Fire Rated, Acoustic Insulation of 36 - 44 dB Rw. Visible Vertical Seal



Product Summary

A slimline and lightweight movable wall system, non fire rated and with high acoustic properties. Lightweight construction makes the system very easy to operate

Certification

European Norm	No Harmonised European Norm
Product Classification	n/a (No Harmonised European Norm)
EC Certificate of Conformity No.	n/a (No Harmonised European Norm)
Certifire No.	n/a
Declaration of Performance	n/a (No Harmonised European Norm)
Other Test Evidence	n/a

BIM Assist™

BC(A)R Assist™*

Guarantee

2 Years

Last Reviewed

16/08/2019

* ROI Only

For the purpose of continual product development, KCC reserves the right to change specifications without notice.
Please accept all dimensions as approximate. E&OE. © KCC Group 2026.

www.thekccgroup.com

Description

Parthos Slimline & Lightweight Movable Wall System, Non Fire Rated, Acoustic Insulation of 36 - 44 dB Rw. Visible Vertical Seal



Features

- Slimline & lightweight moveable wall system designed to eliminate the need for floor guides
- Reduced space requirement when parked
- Easy to use, due to lightweight construction
- Solid panel, straight wall system
- Non fire rated
- Excellent acoustic properties of 36 to 44 dB Rw
- Extensive design options that include walls that can contain single or double doors
- Available in a broad range of finishes
- Strong aluminium and wood stable and self supporting frame provides heights of up to 3,050mm
- Multiple stacking possibilities



Technical Characteristics

- Panel Thickness: 80mm
- Panel Height: 1,500mm-3,050mm
- Panel Width: 600-1,240mm
- Frame Construction: Aluminium and wood
- Board Material: 10mm, part of frame construction
- Walls and Ceiling Tracks: Heavy duty, straight
- Floor Track: Not required
- Carrier: Ball bearing trolleys
- Fire Safety: Non fire rated
- Vertical Profiles: Aluminium construction, Black EPDM rubber with double sealing profiles
- Pressure Sleeves: Black aluminium with double sealing profiles
- Operation of Pressure Sleeves: Manual
- Doors: Single or double door, in panel or fixed single door
- Sound Insulation: 36, 40, 42, 44 dB Rw
- Weight: 20-37kg/m² (approximate and variable against sound insulation value)

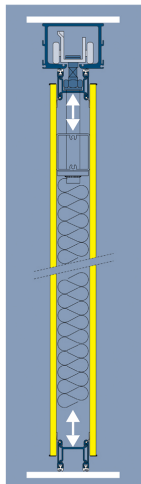

Sectional View

- The smooth running ball bearing track system is typically concealed in the ceiling
- The image shows the pressure sleeves at the ceiling and at the floor. Once the wall is deployed and in position, these sleeves are activated manually via a crank handle

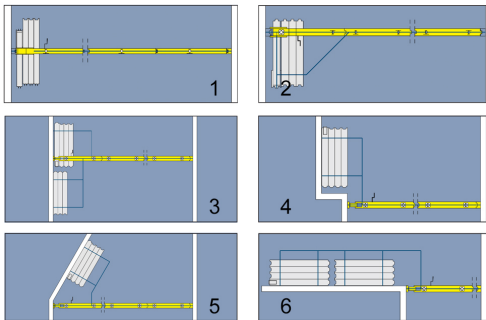

Popular Parking Options

- ① One point suspension
- ② One point suspension with forced guidance
- ③ ④ ⑤ ⑥ Two point suspension with cross guidance

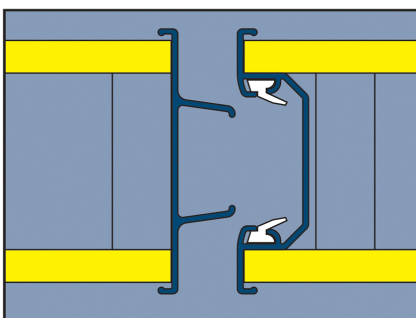

Cross Sectional View

- The Palace 80 system has a visible seal as shown



Installation Examples

- The cranked handle deploys the ceiling and floor seals



Installation Examples

- Palace 80



Installation Examples

- Palace 80



Installation Examples

- Palace 80 ceiling track

Description

Parthos Slimline & Lightweight Movable Wall System, Non Fire Rated, Acoustic Insulation of 36 - 44 dB Rw. Visible Vertical Seal

**Specification Text****MOVEABLE WALL SPECIFICATION**

- Manufacturer: KCC Group / Parthos
- Product reference: KW-PALACE 80/NFR
- Type: Parthos Slimline & Lightweight Movable Wall System
- Fire: Non Fire Rated
- Panel Thickness: 80mm
- Panel Height: 1,500mm-3,050mm
- Panel Width: 600-1,240mm
- Frame Construction: Aluminium and wood
- Board Material: 10mm, part of frame construction
- Walls and Ceiling Tracks: Heavy duty, curved and straight
- Floor Track: Not required
- Carrier: Ball bearing trolleys
- Vertical Profiles: Anodised aluminium with visible seal
- Pressure Sleeves: Aluminium construction, Black EPDM rubber with double sealing profiles
- Operation of Pressure Sleeves: Manual
- Doors: Single or double door, in panel or fixed single door
- Sound Insulation: 36, 40, 42, 44 dB Rw [SPECIFY]
- Finish: [SPECIFY]