

Description

Zero Lopro Low Profile Metal Vision Panel

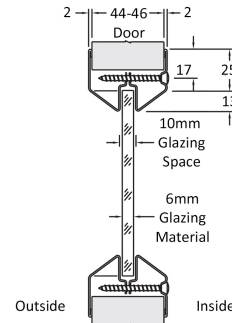
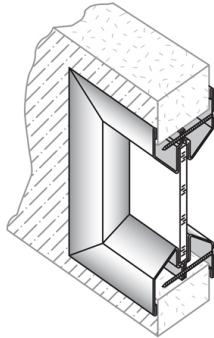

Technical Features

Function & Operation	Flush to the door look, low profile vision panel
Summary of Features	See advanced features

Options: Grade 304 or Grade 316 Stainless Steel

Dimensions

Dimensions: See advanced features

Finishes

Finishes Available: 20GA cold rolled steel, galvanised grey primed, other finished to special order

Certification

European Norm	No Harmonised European Norm
Product Classification	n/a (No Harmonised European Norm)
EC Certificate of Conformity No.	n/a (No Harmonised European Norm)
Certifire No.	n/a
Declaration of Performance	n/a (No Harmonised European Norm)
Other Test Evidence	n/a

BIM Assist™

BC(A)R Assist™*

Guarantee

1 Year

Last Reviewed

30/04/2018

* ROI Only

For the purpose of continual product development, KCC reserves the right to change specifications without notice. Please accept all dimensions as approximate. E&OE. © KCC Group 2023.

Description

Zero Lopro Low Profile Metal Vision Panel

Features

- Anemostat Lopro Low Profile Metal Vision Panel
- Flush to the door look
- Cut out sizes: See list below for cut out sizes
- Clear vision: Please deduct 51mm from the cut out size (H & W)
- Glass Size: Please deduct 27mm from the cut out size (H & W)
- Suitable for 44mm - 46mm metal or timber doors
- 6mm glass thickness as standard
- Galvanised grey primed, other finished to special order
- 20GA cold rolled steel
- Optional Grade 304 or Grade 316 Stainless Steel

**Fire**

- LoPro glazed vision panel systems are assessed for use on previously tested timber based doorsets up to 60 minutes and insulated and uninsulated steel doorsets up to 240 minutes with respect to BS EN 1634-1: 2000 and BS 476: Part 22: 1987

Sizes Available (Width x Height)

- LOPRO 0520: 127 x 508
- LOPRO 0606: 152 x 152
- LOPRO 0608: 152 x 203
- LOPRO 0614: 152 x 356
- LOPRO 0616: 152 x 406
- LOPRO 0618: 152 x 457
- LOPRO 0622: 152 x 559
- LOPRO 0626: 152 x 660
- LOPRO 0630: 152 x 762
- LOPRO 0642: 152 x 1067
- LOPRO 0648: 152 x 1219
- LOPRO 0660: 152 x 1524
- LOPRO 0722: 178 x 559
- LOPRO 0730: 178 x 762
- LOPRO 0736: 178 x 914

For the purpose of continual product development, KCC reserves the right to change specifications without notice. Please accept all dimensions as approximate. E&OE. © KCC Group 2023.

www.thekccgroup.com

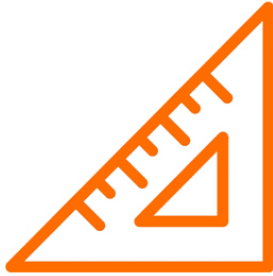
Sizes Available (Width x Height)

- LOPRO 0808: 203 x 203
- LOPRO 0814: 203 x 356
- LOPRO 0820: 203 x 508
- LOPRO 0830: 203 x 762
- LOPRO 0832: 203 x 813 (Popular)
- LOPRO 0842: 203 x 1067
- LOPRO 0848: 203 x 1219 (Popular)
- LOPRO 0860: 203 x 1524 (Popular)
- LOPRO 1010: 254 x 254
- LOPRO 1014: 254 x 356
- LOPRO 1018: 254 x 457
- LOPRO 1022: 254 x 559
- LOPRO 1024: 254 x 610
- LOPRO 1030: 254 x 762
- LOPRO 1032: 254 x 813
- LOPRO 1036: 254 x 914
- LOPRO 1040: 254 x 1016
- LOPRO 1042: 254 x 1067
- LOPRO 1048: 254 x 1219
- LOPRO 1060: 254 x 1524
- LOPRO 1062: 254 x 1575
- LOPRO 1068: 254 x 1727
- LOPRO 1212: 305 x 305
- LOPRO 1218: 305 x 457
- LOPRO 1230: 305 x 762
- LOPRO 1236: 305 x 914
- LOPRO 1248: 305 x 1219
- LOPRO 1260: 305 x 1524
- LOPRO 1262: 305 x 1575
- LOPRO 1616: 406 x 406
- LOPRO 1620: 406 x 508
- LOPRO 1622: 406 x 559
- LOPRO 1624: 406 x 610
- LOPRO 1636: 406 x 914
- LOPRO 1818: 457 x 457
- LOPRO 1822: 457 x 559
- LOPRO 1824: 457 x 610
- LOPRO 1830: 457 x 762
- LOPRO 1836: 457 x 914
- LOPRO 1840: 457 x 1016
- LOPRO 2020: 508 x 508
- LOPRO 2030: 508 x 762
- LOPRO 2060: 508 x 1524
- LOPRO 2222: 559 x 559

Sizes Available (Width x Height)



- LOPRO 2424: 610 x 610
- LOPRO 2432: 610 x 813
- LOPRO 2436: 610 x 914
- LOPRO 2448: 610 x 1219
- LOPRO 2460: 610 x 1524
- LOPRO 2472: 610 x 1829
- LOPRO 3232: 813 x 813
- LOPRO 3248: 813 x 1219

To calculate the clear vision & glass dimensions please see 'features'

Description

Zero Lopro Low Profile Metal Vision Panel

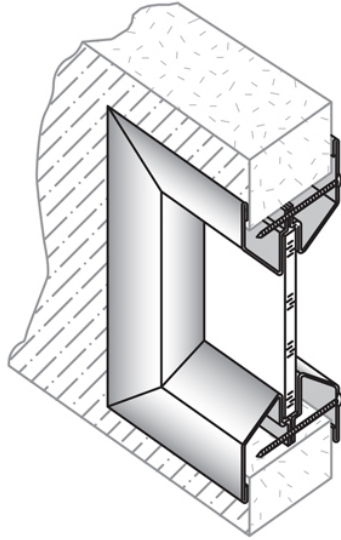

Specification Text

DOORS / DOOR COMPONENTS

- Manufacturer: Zero Seals
- Product reference: FPD-LOPRO
- Type: Anemostat Lopro Low Profile Metal Vision Panel
- Size: [SPECIFY]
- Material/ finish: [SPECIFY FINISH]

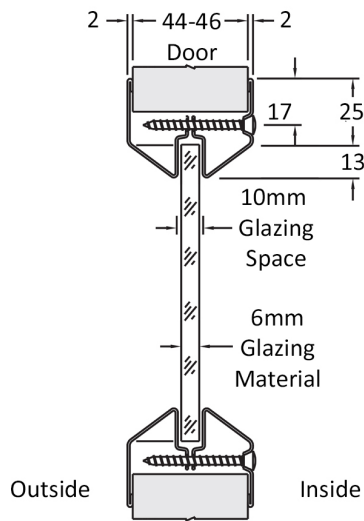

For the purpose of continual product development, KCC reserves the right to change specifications without notice. Please accept all dimensions as approximate. E&OE. © KCC Group 2023.