

Description

Abloy Handle Operated Electro Mechanical Panic Security Lock c/w Electro-mechanically Controlled Clutch for Double Leaf Doors.
55mm Backset (809NE7014540000)

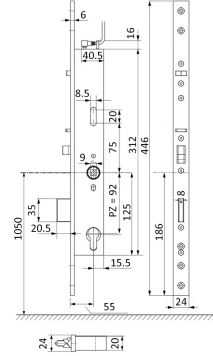

Technical Features

Function & Operation Handle operated electro mechanical panic security lock for double leaf doors

Summary of Features See advanced features

Options Backset: 35, 40, 45, 55, 65, 80mm

Dimensions

Dimensions See drawing

Finishes

Finishes Available Forend: Satin Chrome Plated

Certification

European Norm hEN179, hEN1125, hEN14846

Product Classification hEN179: ③⑦⑦B①③④②A A
hEN1125: ③⑦⑦ B ①③②②(A B)
B
hEN14846: ③S⑥C-L⑥①③

EC Certificate of Conformity No. See DOP

Certifire No. n/a

Declaration of Performance DoP-809NE7.00

Other Test Evidence n/a

BC(A)R Assist™*

Guarantee

1 Year

Last Reviewed 19/01/2024

* ROI Only

For the purpose of continual product development, KCC reserves the right to change specifications without notice. Please accept all dimensions as approximate. E&OE. © KCC Group 2025.

Description

Abloy Handle Operated Electro Mechanical Panic Security Lock c/w Electro-mechanically Controlled Clutch for Double Leaf Doors.
55mm Backset (809NE7014540000)



Features

- Self-activating panic lock for double leaf doors with electro-mechanically clutch controlling the external lever handle
- Egress always possible utilising the panic function design
- Fulfills the requirements for burglary-resistant doors, fire doors, emergency exit doors and panic doors in accordance with EN 179, EN 1125 & EN 14846
- A mechanical sequence control system reliably prevents unwanted extension of the bolt when the door is open
- Suitable for DIN left / Right applications
- Panic side outwards or inwards opening, site reversible
- The fail-locked or fail-unlocked operating mode can be switched on the lock
- Integrated electronic control device for external triggering or connection to the ASSA ABLOY Hi-O bus System
- Integrated monitoring functions via contactless sensors for status query via the external OneSystem IO module:
 - Door status via strike plate contact
 - Bolt retracted and bolt extended
 - Cylinder monitoring
 - Handle follower monitoring inside and outside
 - Status handle clutch engaged/disengaged
- Solid surface hardened deadbolt with 20mm throw, transverse shear stress 20,000N
- Compatible with Euro profile cylinders
- 6mm forend for added security
- Bolt through fixings

Technical Characteristics



- Input operating voltage: 12 -24 V DC +/- 15%
- Rated current consumption: 50 mA (24 V)/60 mA (12 V)
- Current consumption (clutch active): 80 mA (24V/ 120 mA (12V)
- Backset options: 35, 40, 45, 55, 65, 80 mm
- Lock centres: 92 mm (prepared for Euro profile cylinder)
- Bolt throw: 20.5 mm
- Material face plate: Chrome-plated steel
- Handle follower: 9 mm
- Monitoring: Yes
- Top locking: No
- Self-locking system: Yes
- Door type: Aluminium/steel profile
- Functions: Handle-operated
- Door system: Double-leaf door
- Leaf type: Active door leaf



KEL-N59550

- An Abloy connecting cable is required and must be specified separately

Description

Abloy Handle Operated Electro Mechanical Panic Security Lock c/w Electro-mechanically Controlled Clutch for Double Leaf Doors.
55mm Backset (809NE7014540000)

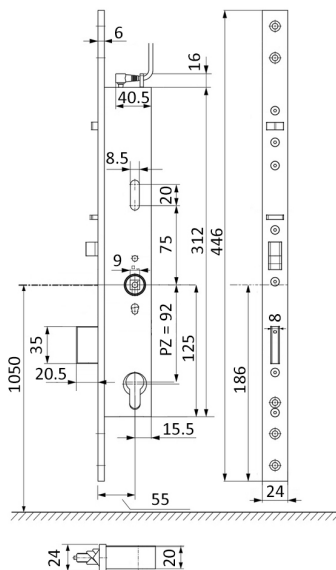

Specification Text

ELECTROMECHANICALLY OPERATED LOCKS & STRIKING PLATES

- Standard: To BS EN 14846.
- Electromechanically operated locks & striking plates: CE marked.
- Manufacturer: Abloy
- Product reference: KEL-809NE7-55
- Abloy Handle Operated Electro Mechanical Panic Security Lock c/w Electro-mechanically Controlled Clutch for Double Leaf Doors. 55mm Backset (809NE7014540000)

- Material/ finish: Forend: Satin Chrome Plated

- Additional requirements: n/a

PERFORMANCE SPECIFICATION FOR ELECTROMECHANICALLY OPERATED LOCKS & STRIKING PLATES

- Standard: To BS EN 14846.

- Electromechanically operated locks & striking plates: CE marked.

- Minimum classification grades:

- Category of use: 3.

- Durability: S

- Door mass: 6

- Suitability for use on fire/ smoke doors: C

- Safety: No Requirement.

- Corrosion resistance: L

- Security: 6

- Status indication: 1

- Electrical manipulation: 3

- Material/ finish: Forend: Satin Chrome Plated

- Additional requirements: n/a