

Description

Briton Surface Mounted Panic Bolt c/w Top & Bottom Locking Points

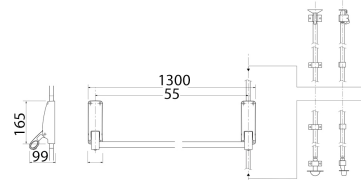

Technical Features

Function & Operation Surface mounted push bar panic bolt for single door applications. Depressing the bar provides safe and speedy egress

Summary of Features See Advance Features

Options n/a

Dimensions

Dimensions See drawing

Finishes

Finishes Available Silver

Certification

European Norm hEN1125:2008

Product Classification ③⑦⑥ B①③②②A A

EC Certificate of Conformity No. See DOP

Certifire No. CF5506

Declaration of Performance DOP AL-0000402080

Other Test Evidence n/a

BIM Assist™

CE

Certifire

BC(A)R Assist™*

Guarantee

10 Years

Last Reviewed

25/07/2022

* ROI Only

For the purpose of continual product development, KCC reserves the right to change specifications without notice. Please accept all dimensions as approximate. E&OE. © KCC Group 2025.

Description

Briton Surface Mounted Panic Bolt c/w Top & Bottom Locking Points

**Features**

- Briton Surface Mounted Panic Bolt c/w Top & Bottom Locking Points
- Suitable for timber doors
- Min / max door width (per leaf): 665mm / 1300mm
- Max door height: 2500mm (shoot extensions available for taller doors)
- Push bar can be cut on site
- Site reversible
- Successfully tested to EN 1125 & EN 179
- CE Marked

Description

Briton Surface Mounted Panic Bolt c/w Top & Bottom Locking Points



Specification Text

571 EMERGENCY EXIT DEVICES

- Standard: To hEN 1125.
- Emergency exit devices for locked doors on escape routes: CE marked.
- Manufacturer: KCC Group
- Product reference: KE-376SE
- Type: Briton Surface Mounted Panic Bolt c/w Top & Bottom Locking Points

- Material/ finish:[SPECIFY FINISH]

- Additional requirements: Certifire Approved, 10 Year Warranty

572 PERFORMANCE SPECIFICATION FOR EMERGENCY EXIT DEVICES

- Standard: To hEN 1125
- Emergency exit devices for locked doors on escape routes: CE marked.
- Minimum classification grades:
- Category of use: 3
- Durability: 7
- Door mass: 6
- Suitability for use on fire/ smoke doors: B
- Safety: 1
- Corrosion resistance: 3
- Security: 2
- Projection of device: 2
- Type of device: A
- Field of application: A
- Material/ finish: [SPECIFY FINISH]

