

Description

KCC QBIQ Full Glass, Double Glazed Wall System



Product Summary

IQ Structural – a futuristic full-glass, double-glazed wall system with improved acoustic properties. Non fire rated

Certification		BIM Assist™	
European Norm	No Harmonised European Norm	BC(A)R Assist™*	
Product Classification	n/a (No Harmonised European Norm)		
EC Certificate of Conformity No.	n/a (No Harmonised European Norm)		
Certifire No.	n/a	Guarantee	2 Years (Conditional)
Declaration of Performance	n/a (No Harmonised European Norm)	Last Reviewed	15/08/2019
Other Test Evidence	n/a	* ROI Only	

Description

KCC QBIQ Full Glass, Double Glazed Wall System



Features

- Full glass, double glazed wall & door system
- High acoustic insulation
- Minimalist floor and ceiling profiles of 33 mm in height
- Practically seamless with fully transparent 0-joints
- Wide range of colours and finishes are available
- Extensive selection of compatible doors
- Non fire rated

Technical Characteristics

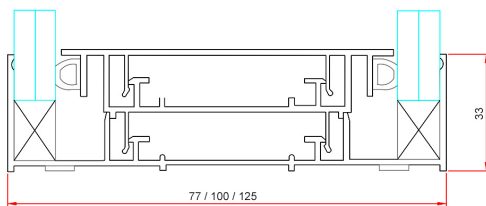

IQ Structural Floor & Ceiling Track

- Wall thickness: 77, 100 or 125 mm
- Floor Track: Aluminium profile, 33 mm high with acoustic tape providing sound-proofing between the track and the floor
- Ceiling Track: Aluminium profile, 33 mm high with acoustic tape providing sound-proofing between the track and the ceiling
- Glazed wall sections: Up to 3000mm in height, double glazed, 66.A2 (with a transparent plastic interlayer – PVB, for enhanced acoustic performance) or 66.2 glass (without PVB), 2 x 12.76mm thickness.
- Clad wall sections: Up to 1200mm in height as standard, other sizes are available. Sections can include dry wall in plaster, vinyl, melamine or in steel
- Doors: Full glass, 10mm tempered, up to a maximum height of 2700mm (can be increased under special arrangement)
- Doors: Wooden door with high pressure laminate (HPL) or veneer finish
- Door frames: Aluminium block frame with single and / or double rubber seal
- Section joints: Transparent hairline joint, flat strip and / or v-seam / 0-joint
- Profile metallic finishes: Alu chrome, RAL9006 (white aluminium)
- Profile colours: Powder coated in any RAL colour and with a gloss level of 30% or 70%
- Acoustic STC rating: From $R_w=44\text{dB}(1)$ till $R_w=56\text{dB}(1)$

(1)=subject to final design and site conditions



Qbiq Projects

- Double glass partition c/w blinds between the glass

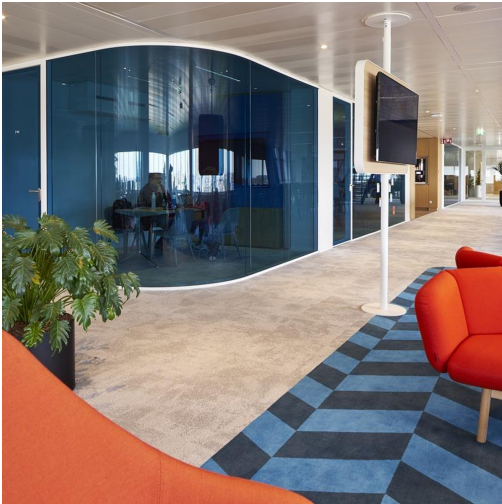

Qbiq Projects

- Blue curved glass



Qbiq Projects

- Glass partitioned wall c/w coloured film



Qbiq Projects

- Double glass free standing office unit



Qbiq Projects

- Corridor with double glass partition and framed doors

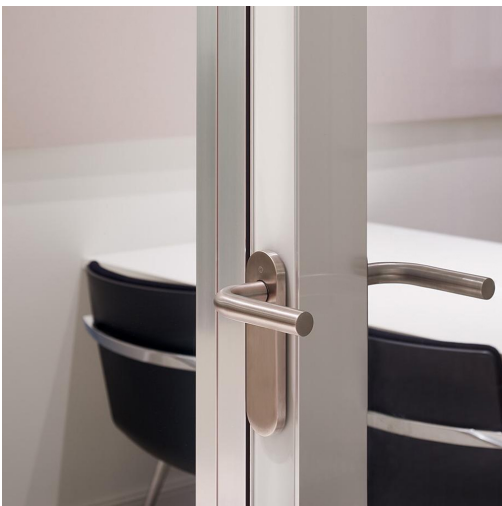

Qbiq Projects

- Double glass flush door with Amsterdam lever handle



Qbiq Projects

- Double glass stair wall

Description

KCC QBIQ Full Glass, Double Glazed Wall System



Specification Text

GLAZED WALL SPECIFICATION

- Manufacturer: KCC Group / Qbiq B.V.
- Product reference: KW-IQ STRUCTURAL NFR
- Type: Full Glass, Double Glazed Wall System
- Fire: None Fire Rated

- TRACK

- Thickness: 77, 100 or 125 mm [SPECIFY]
- Floor & Ceiling: Aluminium profile, 33 mm high with acoustic tape providing sound-proofing between the track and the floor

- GLAZED WALL SECTIONS

- Up to 3000mm in height, double glazed, 66.A2 (with a transparent plastic interlayer – PVB, for enhanced acoustic performance) or 66.2 glass (without PVB), 2 x 12.76mm thickness*.
- Section joins: Transparent hairline joint, flat strip and / or v-seam / 0-joint

* Glass selection is determined by the Acoustic Target

- CLAD WALL SECTIONS

- Up to 1200mm in height as standard, other sizes are available. Sections can include dry wall in plaster, vinyl, melamine or in steel
- Section joins: Transparent hairline joint, flat strip and / or v-seam / 0-joint

- DOORS & FRAMES

- Full glass, 10mm tempered, up to a maximum height of 2700mm
- Wooden door with high pressure laminate (HPL) or veneer finish
- Frames: Aluminium block frame with single and / or double rubber seal

- FINISHES

- Profile metallic finishes: Alu chrome, RAL9006 (white aluminium)
- Profile colours: Powder coated in any RAL colour and with a gloss level of 30% or 70%

- ACOUSTIC, RW

- From $R_w=44\text{dB}$ to $R_w=56\text{dB}$ *

*Dependent upon the final design

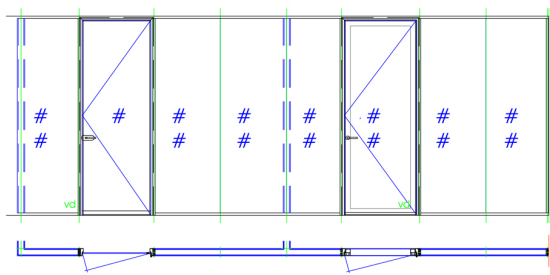

Typical Arrangement